

# TARA Studio



updated 23rd November 2009



The **TARA Studio** is an intimate theatre venue in South London located by Earlsfield main-line station in Wandsworth.

**Directions:**

**TARA Studio** is almost opposite Earlsfield Rail Station with regular links to Clapham Junction, Waterloo and Surrey, and buses into Tooting, Battersea, Putney and Central London (77, 44, 270).

From Earlsfield Station, turn right as you exit the station, walk under the railway bridge and Tara is opposite at number 356 Garratt Lane, SW18 4ES. Telephone 0208 333 4457, fax 0208 870 9540.

<http://maps.google.co.uk/maps?f=q&hl=en&geocode=&q=SW18+4ES&ie=UTF8&z=16&iwloc=addr&om=1>

Artists and companies must comply with all TARA policies and procedures, these are available upon request.

**LX**

**Board Strand**

GSX up to 100 channels

24 dimmers. patchable circuits

Patch panel located in Studio upstage left.

Dimmers and DMX 1<sup>st</sup> floor landing cupboard

DMX link to board, box right of production corner

**Lantern stock**

x 1 Source 4 Parcan

x 10 minuets fresnels

x 4 minuet profiles

x 2 1k floods (used as house lights)

x 3 ADB fresnels

Very limited stock of barn doors, gel frames and gobos

Projectors available upon request

**Grid height to stage 3m 23cm**

**SOUND**

**Sound desk**

Yamaha digital mixing console O1V

**Amplifier**

LAB Gruppen 1200C 4 CH 4 X 380W

**Speakers**

x 2 EV S40

Flying Frame and safety EV S40 MBB

**2 CD players**

x 1 Denon DCD-715

x 1 Denon DN-C630 PRO

x 2 SM 58 microphones

Baby grand piano (John Broadwood)

## **MISC**

Stage is concrete covered in Grey double thickness harlequin dance floor.

Supply of blacks and legs. No borders.

Rigging from 2 ladders

2 lengths of RSJ span the Studio. Positioned above the LX truss; load bearing but not tested for rating.

## **Stage area**

Approx: 6.1 x 5.4 metres, irregular shape.

## **DRESSING ROOM**

TARA Studio does not have a designated dressing room. However the workshop room on the top floor of the building is made available to use by performers as appropriate; it accommodates around 6 people. Washing machine, ironing board and iron are provided.

Stage Management staff need to liaise closely with performers and Front-of-House Manager regarding calling performers to the stage as there is only one route from the Dressing Room through front-of-house and into the Studio. Tara Studio does not have a show relay, cue lights or paging.

## **HEALTH AND SAFETY**

TARA management requires all risks in association with working and performing in the Studio to be assessed and safe working practises be adhered to.

A Risk Assessment template is attached.

## **INSURANCE**

TARA management requires companies and artists working in the Studio to have Public Liability Insurance to the minimum value of £5,000,000.

## **ENTERTAINMENTS LICENSE.**

Performances **must end by 10.45pm** Monday to Sunday.

Fire Exits: the Studio has 2 Fire Exits, the front-of-house entrance and one from upstage left which leads to a back alley behind a parade of shops.

**Audience capacity 70:** 50 seated, 20 on cushions. Seating is arranged on 2 sides, on modular bench seating units with cushion pads.

[www.tara-arts.com](http://www.tara-arts.com)

Tara, 356 Garratt Lane, London, SW18 4ES

020 8333 4457

## Tara Studio





TARA Studio LX plan (not to scale)

PATCH PANEL

FIRE EXT

	10	11	12	13	14	15	
1							48
2							47
3	16	17	18	19	20	21	46
4							45
5	22	23	24	25	26	27	44
6							43
7							42
8	28	29	30	31	32	33	41
9							40
	34	35	36	37	38	39	

FRONT OF HOUSE ENTRANCE

LX & SOUND DESK

# TARA STUDIO GROUNDPLAN - with Grid

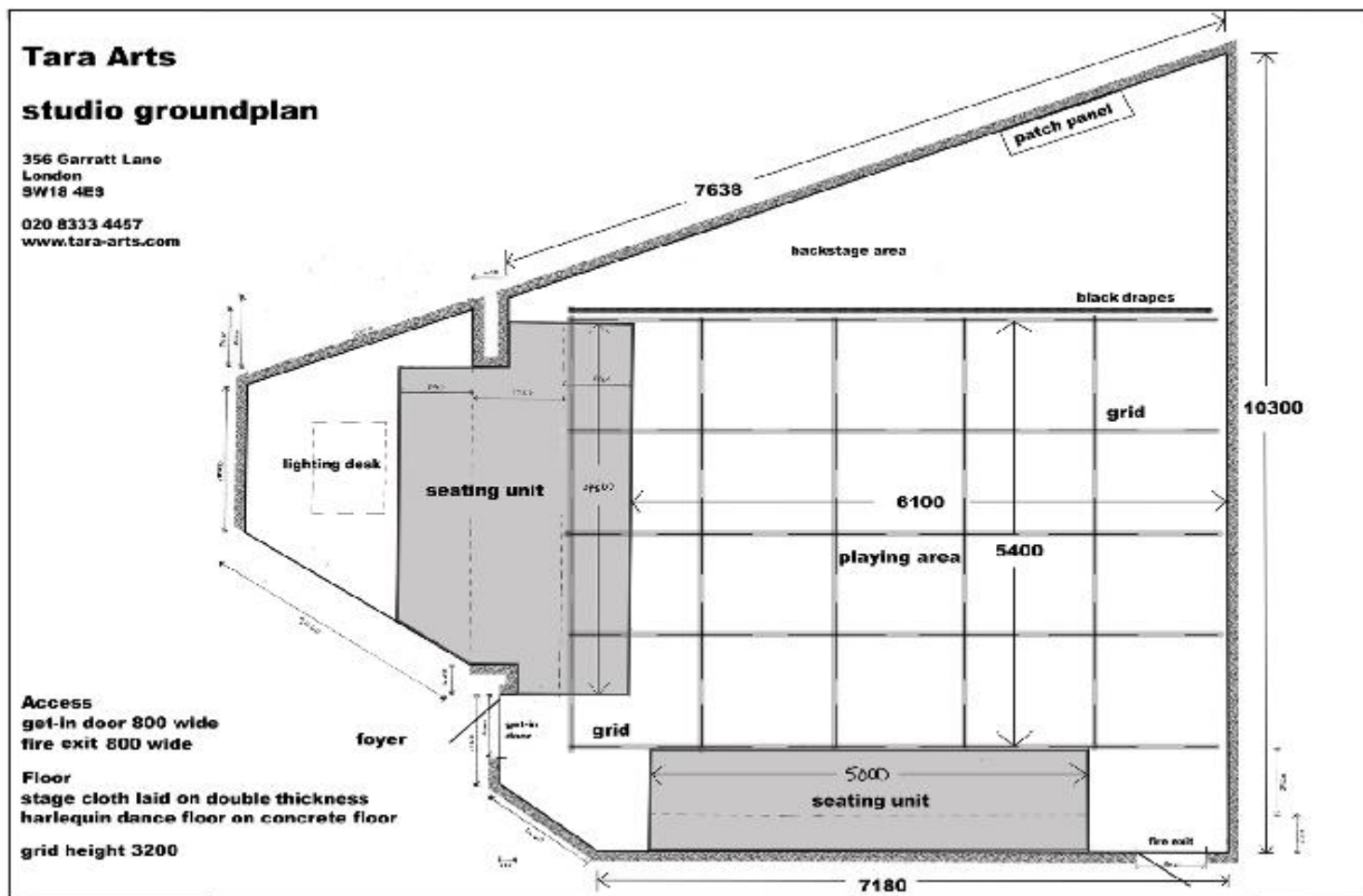

# TARA STUDIO GROUNDPLAN - minus Grid

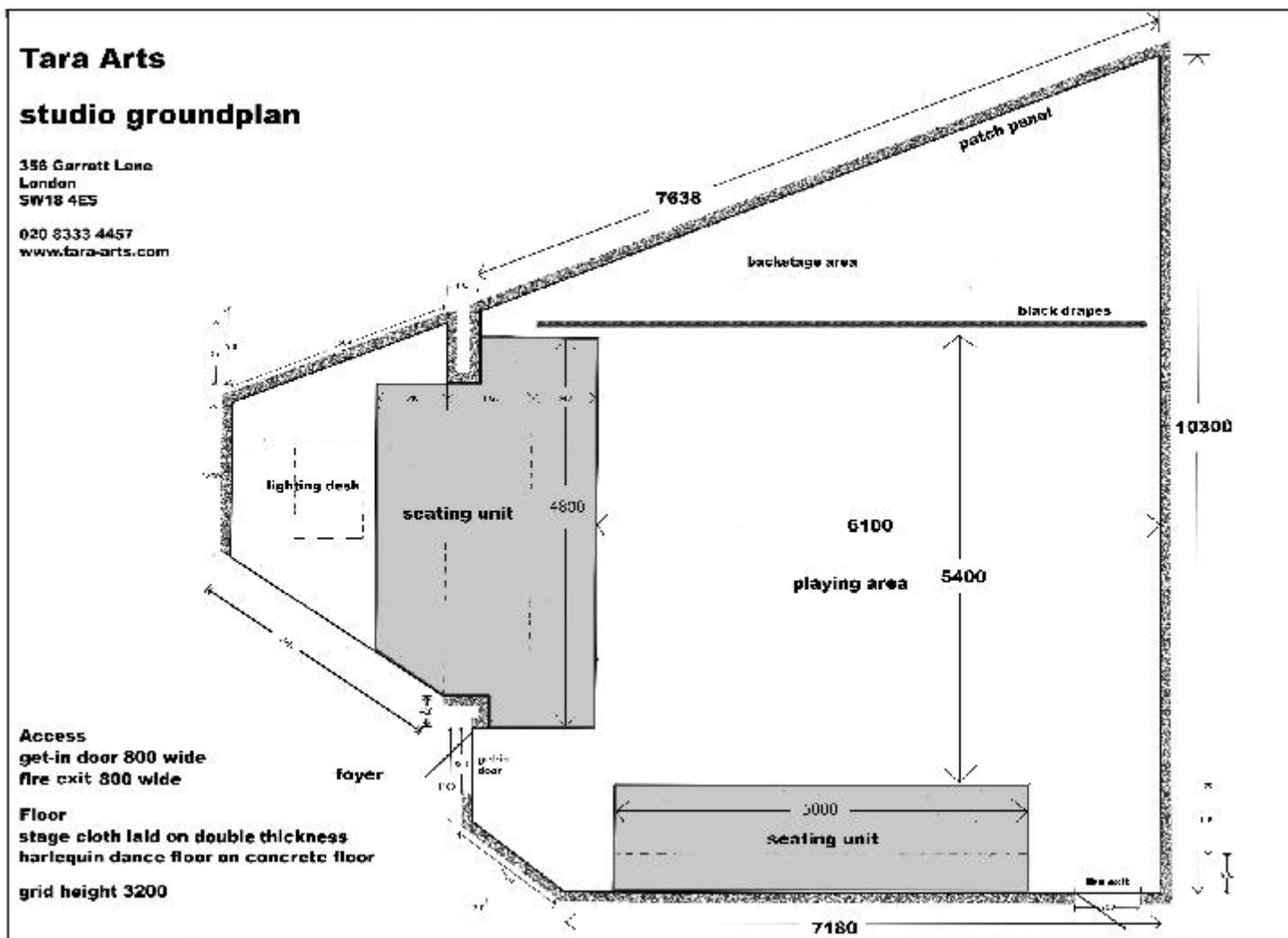



## Directions to Tara:

Overground Trains from Waterloo, Vauxhall or Clapham Junction to Earlsfield. (12 mins approx from Waterloo)

If coming from Waterloo, Earlsfield trains are usually at Platforms 1-5. If coming from Vauxhall tube, exit the tube and go to Platform 8 of the overground part of Vauxhall. Trains to Earlsfield stop at this platform. From Clapham Junction trains to Earlsfield are usually from Platform 11 (1 stop). Alternatively, buses can be taken from Tooting Broadway Station to Earlsfield, these are the 77, 44, or 270.

From Earlsfield Station, simply turn right as you exit the station, walk under the railway bridge and Tara Arts is right opposite at 356 ie we are literally opposite the train station.

### RISK ASSESSMENT FORM

REF. NUMBER	
LOCATION	
ACTIVITY / SITUATION	

1 Identify the risks present assuming that there are no controls in place, using a tick where appropriate

IDENTIFIED HAZARDS	PERSONS AT RISK					WORST CASE SEVERITY					LIKELIHOOD					RISK
	E M P L O Y E E	C O N T R A C T O R	P U B L I C	C L I E N T	V I S I T O R	F A T A L	M A J O R	M I N O R	N O I N J U R Y	D A M A G E	F R E Q U E N T	P R O B A B L E	P O S S I B L E	R E M O T E	I M P R O B A B L E	

1a New or expectant mothers

Does this activity constitute an unacceptable risk to new or expectant mothers? <small>(please tick yes or no)</small>	Yes	No
If yes, state what action is required		

1b Operations / Medical Treatment

Does this activity constitute an unacceptable risk to persons receiving medical treatment? <small>(please tick yes or no)</small>	Yes	No
If yes, state what action is required		

1 c Young Persons

Does this activity constitute an unacceptable risk to young workers (persons between 16 and 17 years old)? <small>(please tick yes or no)</small>	Yes	No
If yes, state what action is required		

2 Existing control measures

Hazard Ref.Number	Existing Controls	Controlled (Please Tick)	
		Yes	No

3 Complete this section based upon the findings from section 2 above

ACTION PLAN				
Hazard Ref.	Action Required	Target Date	Action By (Manager etc.)	Date Actioned
Assessors Name	Jonathan Kennedy		Date	
Signature			Review Date	
Assessors Job Title	Executive Director			